

Performance curves 50Hz

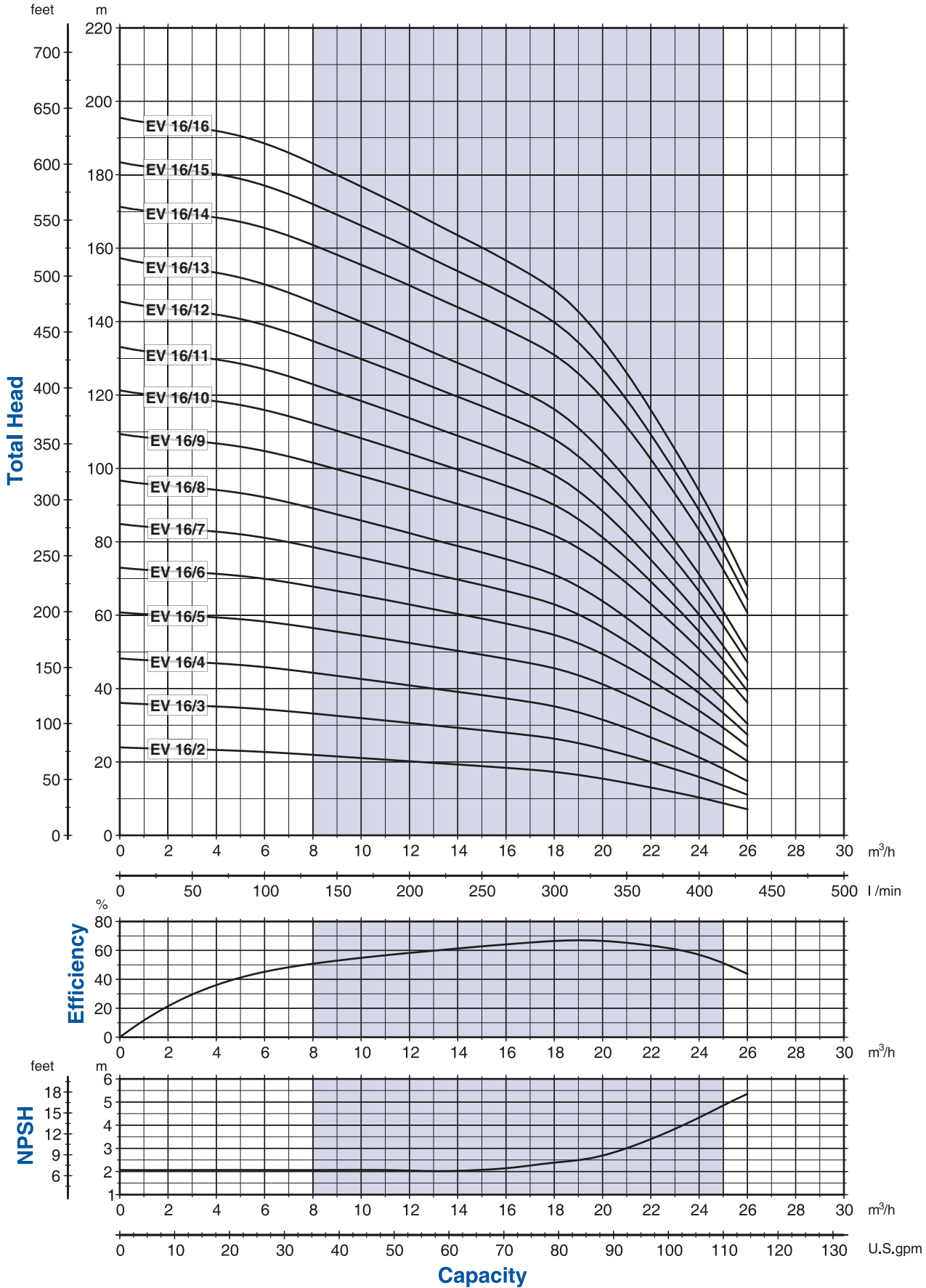

00110046 05/2009

The hydraulic characteristics are guaranteed, according to ISO standard 9906, Annex A, grade 2.



It is our policy to continuously develop and improve our products, therefore, we reserve the right to amend specifications without prior notice.

by Franklin Electric

F version

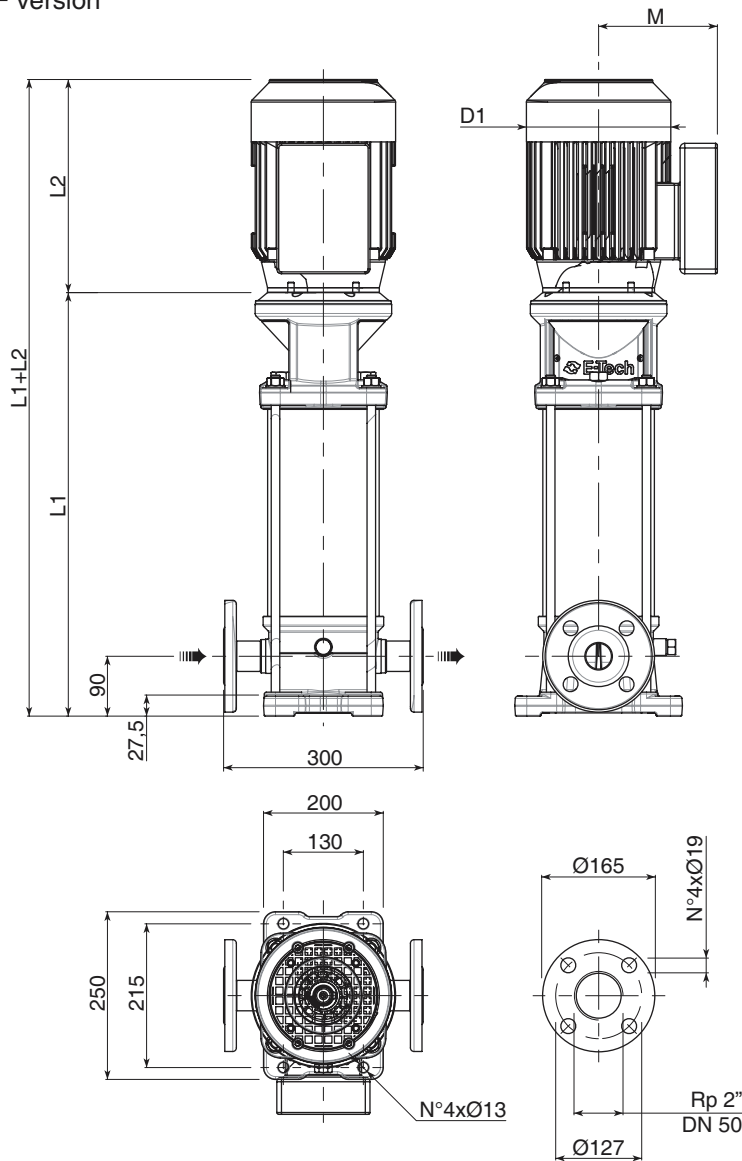

T version

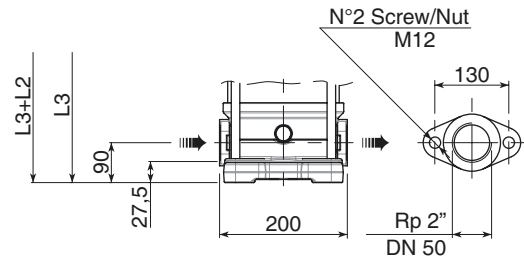

V version

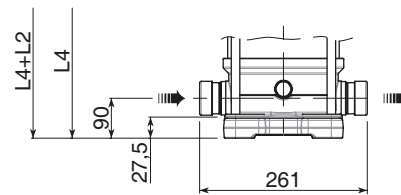

C version

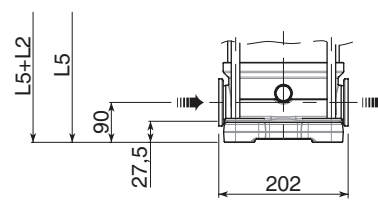

00114014_05/2009

F version Round flanges on body type PN25: the pump is supplied with joints and bolts without counterflanges (Optional accessories).

V version Connections with rapid fittings type "Victaulic": the pump is supplied without the collars (Optional accessories).

T version Oval flanges on body type PN16: the pump is supplied without oval counter flanges for pipe to be screwed, joints and bolts (Optional accessories).

C version Connections with round fittings type Clamp-FlexiClamp: the pump is supplied without collars (Optional accessories).

| Pump Model | Motor | | Dimensions (mm) | | | | | Weight | | | | | | |
|------------|-------|------|-----------------|---------|---------|-------|-------|--------|---------|---------|---------|---------|------|---------------|
| | kW | Size | L1 F | L2 | | L3 T | L4 V | L5 C | M | | D1 | | Pump | Electric Pump |
| EV 16/2 | 1.5 | 90 | 382.5 | 1-PHASE | 3-PHASE | 382.5 | 382.5 | 382.5 | 1-PHASE | 3-PHASE | 1-PHASE | 3-PHASE | 19 | 33 |
| EV 16/3 | 2.2 | 90 | 420 | - | 267 | 420 | 420 | 420 | - | 138 | - | 180 | 20 | 36 |
| EV 16/4 | 3 | 100 | 467.5 | - | 306 | 467.5 | 467.5 | 467.5 | - | 145 | - | 196 | 21.5 | 44.5 |
| EV 16/5 | 4 | 112 | 505 | - | 328 | 505 | 505 | 505 | - | 161 | - | 225 | 22.5 | 56 |
| EV 16/6 | 5.5 | 132 | 565 | - | 362 | 565 | 565 | 565 | - | 195 | - | 248 | 28.5 | 74.5 |
| EV 16/7 | 5.5 | 132 | 602.5 | - | 362 | 602.5 | 602.5 | 602.5 | - | 195 | - | 248 | 29.5 | 75.5 |
| EV 16/8 | 5.5 | 132 | 640 | - | 362 | 640 | 640 | 640 | - | 195 | - | 248 | 30.5 | 76.5 |
| EV 16/9 | 7.5 | 132 | 677.5 | - | 362 | 677.5 | 677.5 | 677.5 | - | 195 | - | 248 | 31.5 | 84.5 |
| EV 16/10 | 7.5 | 132 | 715.5 | - | 362 | 715.5 | 715.5 | 715.5 | - | 195 | - | 248 | 32.5 | 85.5 |
| EV 16/11 | 7.5 | 132 | 753 | - | 362 | 753 | 753 | 753 | - | 195 | - | 248 | 33.5 | 86.5 |
| • EV 16/12 | 11 | 132 | 790.5 | - | 420 | 790.5 | 790.5 | 790.5 | - | 195 | - | 248 | 34.5 | 87.5 |
| • EV 16/13 | 11 | 132 | 828 | - | 420 | 828 | 828 | 828 | - | 195 | - | 248 | 35 | 88 |
| • EV 16/14 | 11 | 132 | 865.5 | - | 420 | - | 865.5 | 865.5 | - | 195 | - | 248 | 36 | 89 |
| • EV 16/15 | 11 | 132 | 903 | - | 420 | - | 903 | 903 | - | 195 | - | 248 | 37 | 90 |
| • EV 16/16 | 11 | 132 | 940.5 | - | 420 | - | 940.5 | 940.5 | - | 195 | - | 248 | 38 | 91 |

• Motor flange size 132 rated 11kW not included in IEC 72-1 standards